

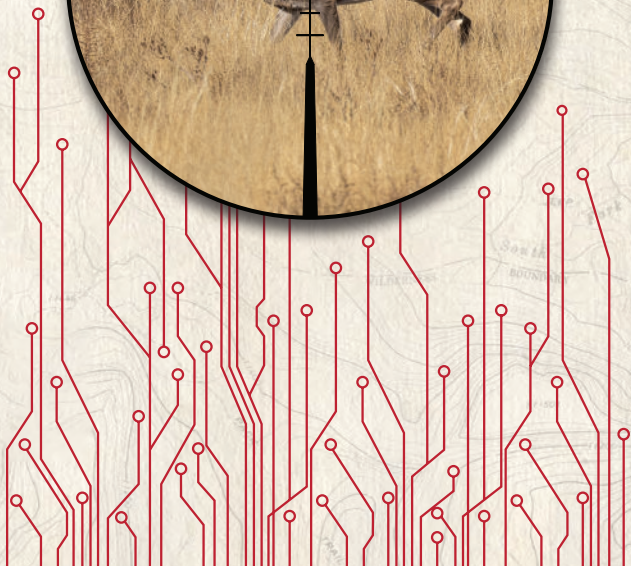

VERACITY PH

4-20x50mm



INTRODUCTION

This user guide includes information for the Veracity PH 4-20x50mm riflescope. Before mounting and using your riflescope, please review this user manual thoroughly.

Congratulations on choosing the Veracity® PH riflescope from Burris®. This riflescope offers premium optical clarity, a built in Heads-Up Display (HUD), Click-less Digital Elevation Turret, Bluetooth® BurrisConnect Mobile App connectivity for uploading custom ballistic data, all combined to offer the most precise tech-driven optic from Burris yet.

Full functionality of the Veracity PH requires the use of the BurrisConnect Mobile App. Installation requires a high-speed internet connection. It is recommended that you download the app at home and not at the range or in the field.



TABLE OF CONTENTS

- I Key Features**
- II Mounting the Veracity PH**
 - Eye Piece Focusing
 - Parallax/Focus Adjustment
- III Elevation and Windage Adjustment**
 - Mechanical Elevation Adjustment
 - Mechanical Zeroing and Zero Turn Stop
 - Windage Adjustment
 - Windage Zeroing
- IV Veracity PH Overview**
- V Powering Up the Veracity PH**
 - Illumination Adjustment
- VI Programming the Veracity PH**
 - Connect to Device
 - Build and Upload Custom Ballistic Profile
 - Zero Digital Elevation Knob
 - Truing Ballistic Data
- VII Care and Maintenance**
- VIII Specifications**
- IX Wind MOA Reticle**
- Warranty**

I. KEY FEATURES

- **Mechanical/Digital Click-Less Elevation Turret**

The most precise elevation turret ever in a Burris optic. A click-less elevation turret combined with a digital position sensor removes the need for detents milled into the turret delivering unmatched precision. By removing detents, users can dial to the equivalent of 1/10 MOA. Digital position is displayed on built-in heads-up display offering a perfect balance of efficiency and security. No matter what happens in the field, this optic will get the job done, batteries or no batteries.

- **Heads-Up Display (HUD)**

A built-in heads-up display shows elevation turret position in Yards, Meters, or MOA, rifle cant, distance accurate wind holdover, and battery level.

- **Bluetooth® For BurrisConnect**

Bluetooth connectivity allows pairing to the BurrisConnect App on any smartphone or tablet for building custom ballistic profiles and operating advanced scope features.

- **Wind MOA FFP Reticle**

Veracity PH has a Front Focal Plane design that ensures trajectory compensation is accurate at any magnification.

- **Five Times Zoom System**

Highly versatile 5x zoom system allows for a larger field of view at close ranges and better target acquisition at long ranges.

- **Zero Turn Stop Adjustment Knobs.**

Allows you quickly and easily revert back to the original sight-in setting without leaving the scope or getting lost on the turret.

- **Side Focus Parallax Adjustment**

An easy-to-reach side focus for parallax adjustment.

- **High-Performance Glass**

Provides excellent brightness and clarity with lasting durability – exactly what you expect from Burris.

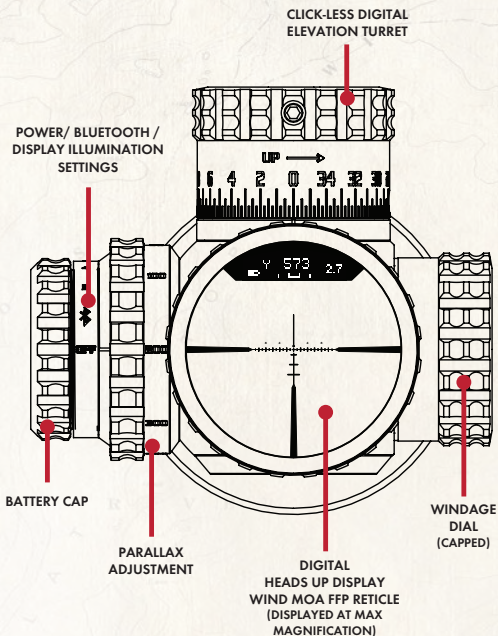

II. MOUNTING THE VERACITY PH

HOW TO USE THE VERACITY PH RIFLESCOPE

WARNING! Make sure your firearm is unloaded before attempting to mount the scope on your firearm. Practice safe firearms handling at all times.

Prior to utilizing the advanced features of the Veracity PH, the optic should be mounted and zeroed like any other rifle scope. It is important to be as precise as possible during this process to get the best results at long ranges.

The Veracity PH require 30mm rings. We recommend using high-quality scope mounts, such as the Burris Signature Zee or XTR Rings and Xtreme Tactical Bases. Quality components ensure that your scope will remain safely and securely mounted and will provide maximum accuracy. Use care and follow the manufacturer's directions regarding the installation of mounts and rings when mounting your scope as damage can be caused by improper mounting.

* It is critical to level your scope with less than 1/2 degree of cant.

II. MOUNTING THE VERACITY PH (CONT)

EYEPIECE FOCUSING

The eyepiece can be focused to adjust the reticle and Heads-Up Display (HUD), so they appear sharp and black. For this procedure, only concentrate on the reticle. Adjustments for HUD can be made later. Follow this procedure to quickly adjust the focus:

- ① After mounting the optic, point the scope at the sky or a plain wall and take a quick glance through the scope. If the reticle appears sharp and black, no further adjustment is necessary.
- ② If the reticle does not appear sharp and black, take quick glances through the scope while rotating the focus ring until the reticle pattern is sharp and black.

NOTE: Do not look through the eyepiece as you turn the focus ring. Your eyes will adjust to the out-of-focus condition.

PARALLAX/FOCUS ADJUSTMENT

Images from different distances can focus in front of or behind the scope's reticle causing a blurry image or reticle. The Parallax/Focus adjustment allows adjusting image focus forward or backward so the reticle and image both appear sharp and clear.

To use the parallax/focus adjustment, rotate the knob on the left side of the adjustment turret, closest to the main scope tube until the numbers corresponding to the known target distance lines up with the reference mark. If the distance is unknown, rotate the adjustment knob clockwise or counterclockwise until the target image is sharply focused.

III. ELEVATION AND WINDAGE ADJUSTMENTS

MECHANICAL ELEVATION ADJUSTMENT

The Elevation Turret located on the top of the optic features a click-less mechanical design paired with a digital position sensor for the most precise level of adjustment found in a riflescope. Traditional elevation turret accuracy is limited to the number of detents physically milled into the turret. The digital sensor allows the Veracity PH to track adjustments 360° or around the equivalency of 1/10 MOA. This section covers adjusting the Mechanical Zero on the Elevation turret.

Adjusting and zeroing the elevation turret requires first adjusting the mechanical (traditional) elevation turret. Lasered markings are equivalent to 1/4 MOA.

- Turning the turret clockwise moves the point of impact down.
- Turning the turret counterclockwise moves the point of impact up.
- For negative elevation adjustment, loosen the zero turn stop screw located at the base of the elevation turret between MOA position 26 and 28.
- The scope has a total of 66 MOA elevation with a 33.8 limit in the single turn dial.

MECHANICAL ELEVATION ZEROING AND ZERO TURN STOP

To set mechanical turret cap to Zero and properly set Zero Turn Stop:

- ① Using the 2mm hex wrench supplied with your scope, loosen the three set screws located just below the top of the knob until they are flush with the outside wall of the turret cap. Make sure they are loose enough to avoid accidentally spinning the turret post.
- ② Gently rotate the turret cap clockwise to zero. This process should also hit the zero turn stop.
- ③ Retighten the three set screws until firm. Do not overtighten.

III. ELEVATION AND WINDAGE ADJUSTMENTS (CONT)

WINDAGE ADJUSTMENT

The Veracity PH features a rotation-limited windage dial to prevent losing reference to windage zero. When properly set, windage maintains 12 MOA or, a half turn of adjustment in the right or left direction from zero position.

If windage is maxed out an additional adjustment is needed during sight-in, loosen the set screws and move the dial in the opposite direction of adjustment and retighten. We recommend walking the dial in at least 10 MOA increments. The windage turret is located on the right side of the tube

- Turning the dial clockwise moves the point of impact left.
- Turning the dial counterclockwise moves the point of impact right.
- The lines on the wind dial are calibrated to equal $\frac{1}{4}$ MOA.
- There is 37 MOA total windage adjustment with 24 MOA in the dial.

WINDAGE ZEROING

To set windage zero:

- ① After zeroing, loosen 2 set screws using the 2mm hex wrench supplied with your scope.
- ② Move windage dial until "0" lines up with the white reference mark
- ③ Tighten the 2 set screws.

IV. VERACITY PH HEADS-UP DISPLAY OVERVIEW

The Veracity PH features a built-in heads-up display and shows customizable ballistic data including dialed elevation distance conveyed in Yards, Meters, or MOA, rifle cant, range compensated wind value, and optic battery level in real time.

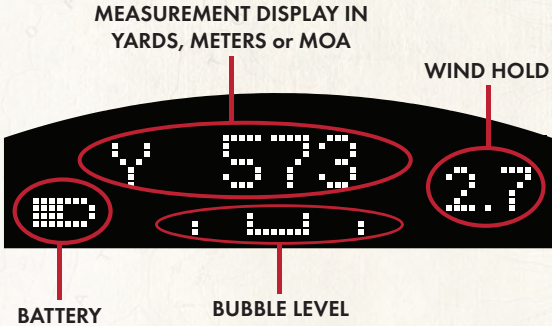

At the bottom of the display is the digital level that will indicate cant. A horizontal line in the center means the scope is level. The line will move to the right or left of center to show reticle cant. The degree of cant can be user defined in the app.



Right Lean



Left Lean



Level



Extreme Right Lean



Extreme Left Lean

If your laser rangefinder only provides line of sight (LOS) distance, a built-in inclinometer will compensate for shooting uphill or downhill. No matter the angle of your shot, the scope automatically calculates the correct aiming point. An icon on the left side of the display indicates when the inclinometer is on. Line of sight distance will be displayed.

ANGLE COMPENSATION INDICATOR



V. POWERING UP THE VERACITY PH

INSTALLING AND REPLACING THE BATTERIES

The HUD and Bluetooth features are powered by two CR2450 3-volt lithium cell batteries. To install new batteries, simply unscrew the battery cap counterclockwise on the illumination knob

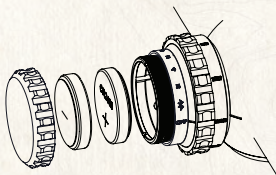

located on the left side of the optic, and install one battery flat side (+) up and the second battery reversed with the flat side (+) down. The batteries should be stacked + to +.

NOTE: For long-term storage (over a month), it is advisable to remove the batteries. Scope data will not be lost with the removal of the batteries.

HUD ILLUMINATION ADJUSTMENT

The intensity of the display's illumination is controlled by a rotary dial located on the left side of the turret. The dial has eight settings: five levels of illumination, the Bluetooth® /Set Up position, and an "Off" at both ends of dial range.

- The OFF positions turns the optic electronics off and should be set in this position when the scope is not in use.
- To prolong battery life, users can select from multiple automatic display and scope sleep mode options between 1 and 12 hours within the BurrisConnect App. App connectivity covered on page 11.
- To wake up the display and restart the timer, rotate the elevation knob, or change the illumination setting.
- To turn the scope back on after auto shut-off, turn the illumination knob to one of the "Off" positions and back on in any illumination setting, or to the communication or Bluetooth® position.

NOTE: Automatic scope shut-off does not completely turn off the scope but instead puts it in sleep mode. To save battery life the illumination knob should be turned to one of the "Off" positions after use.

VI. PROGRAMING THE VERACITY PH

Ensure Batteries have been properly installed in the riflescope.

- 1 Download the **BurrisConnect** App to your smartphone or tablet.



Android





Apple

NOTE: Installation requires a high-speed internet connection. It is recommended that you download the app at home and not at the range or in the field.

CONNECTING TO DEVICE

To Connect to Veracity PH:

- 1 Turn the illumination knob to the Bluetooth®  position.
- 2 Look in the optic to confirm it is powered on and ready to connect. You should see "User Defined Profile" in the HUD.
- 3 On your mobile device, make sure your Bluetooth setting is turned on and open the BurrisConnect App.
- 4 In the BurrisConnect App, Go to "Devices" tab, and add a new device by tapping on either "+."
- 5 Follow the "Connection Assistant" instructions.
- 6 Select the Settings you want for your Veracity PH such as, MOA / Impact Distance, Inclinator, Digital Level Sensitivity, Display Timeout, Scope Auto Off.
- 7 Upload Settings
- 8 Keep the illumination dial in the Bluetooth®  position for the next section, "Build and Upload Custom Ballistic Profile."

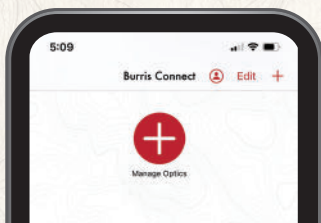

BUILD AND UPLOAD CUSTOM BALLISTIC PROFILE

For this section you will need to know information about your bullet and cartridge including: ammo manufacturer, bullet weight/type, muzzle velocity, BC, altitude, temperature, and sight-in distance.

Build and Download Ballistic Profile:

- ① Go to "Ballistics" Tab and follow on-screen instructions to build custom Rifle and Ballistics profile.
- ② After Ballistic Profile is complete, Select your scope under "Optics Tab"
- ③ Select the desired ballistics profile you created.
 - A. This is an opportunity to rename the profile in "Active Table" field.
 - B. We recommend using naming scheme that communicates changes to your profile. Example "John 143 ELDX 7500ft V1.2"
- ④ Tap "Upload Profile"
- ⑤ To confirm ballistic profile has uploaded, look in the optic and the Ballistic Profile name should appear in the HUD.
- ⑥ **Zero Digital Elevation Knob:** with the mechanical elevation knob in the "0" position, tap "Zero Elevation Knob" in the app.
- ⑦ Turn the illumination dial to the desired illumination setting and you are ready to shoot!

NOTE: ANY CHANGES TO BALLISTIC PROFILE MUST BE REUPLOADED TO YOUR VERACITY PH.

NOTE: TO SEE WHAT PROFILE IS LOADED ON THE OPTIC, TURN TO BLUETOOTH POSITION ON THE ILLUMINATION DIAL AND LOOK AT THE IN-SCOPE HUD.

ZERO DIGITAL ELEVATION KNOB

If the Digital Zero does not match the Mechanical Zero, it can be reset by repeating step number 6 above.

TRUING BALLISTIC DATA

If your Ballistic data does not seem accurate, you can adjust the profile and true data under your custom bullet profile in the "Ballistics"

DIGITAL LEVEL CALIBRATION

The digital level comes calibrated from the factory. It is also possible to calibrate the digital level's horizontal zero using the app. Ensure the rifle and scope are level using a bubble level and connect the scope to the app. Then tap "Zero Digital Level" in the app.

VII. CARE & MAINTENANCE

To protect the objective and ocular lenses, it comes equipped with flip-up scope caps. If the lenses are subjected to dust, dirt or mud, follow these steps to clean and protect the lens surface.

CAUTION - Remove all foreign material from the lens before cleaning with cloth to prevent damage to the lens. Utilizing a compressed air can or an air compressor to blow off any dirt or left over residue is ideal.

Coarse dirt/debris must be removed from the lens surface. The most convenient way to clean the lenses is to use a Burris Lens Pen. Position the scope so particles will fall away from the lens, and then use the Lens Pen to gently whisk away the debris, while blowing on the lens to dislodge the particles. For heavy dirt, like dried mud, use a spray of clean water or lens cleaning fluid to remove the dirt. Your Veracity PH riflescope will provide a reliable performance given reasonable care and treatment.

All moving assemblies are permanently lubricated. Only occasional cleaning of the outside of the scope and the exterior lenses is required. Never disassemble your scope as this will void the warranty. For any other problems, or concerns, consult the Burris Technical Support team.



VERACITY PH

VIII. SPECIFICATIONS

| | |
|--|--------------------|
| Item Number | 200200 |
| Magnification | 4-20x50mm |
| Objective Lens Diameter | 50mm |
| Tube Diameter | 30mm |
| Field of View (Low to High @ 100 yards) | 26 - 5.5 ft. |
| Eye relief (in.) | 3.5 - 4.25 |
| Exit Pupils- Low / High (mm) | 12 - 2.5 |
| Diopter Setting | +2 to -3 |
| Reticle Plane | Front |
| Display Plane | Rear |
| Reticle | Wind MOA FFP |
| Display Illumination | Rotary Dial |
| Battery | CR 2450 x2 |
| Length (in.) | 15 |
| Weight oz. | 27.2 |
| Elevation Turret Marking Graduations | ¼ MOA |
| Elevation Turret Digital Resolution | 1/10 MOA |
| Total Elevation Adjustment Range* | 66 MOA |
| Elevation Turret Travel Limit** | 33.8 MOA |
| Windage Turret Graduations (Clicks) | ¼ MOA |
| Total Windage Adjustment Range* | 37 MOA |
| Windage Turret Travel Limit** | 24 MOA |
| Parallax Focus | Side Focus |
| Parallax/Focus Range | 50 Yd. to Infinity |
| Operating Temperature | -20° to +140° F |

* Example: 50 MOA Total adjustment range equates to roughly 25 MOA in either direction from center

** Rotation-limited dial, see details in section III.

IX. WIND MOA RETICLE

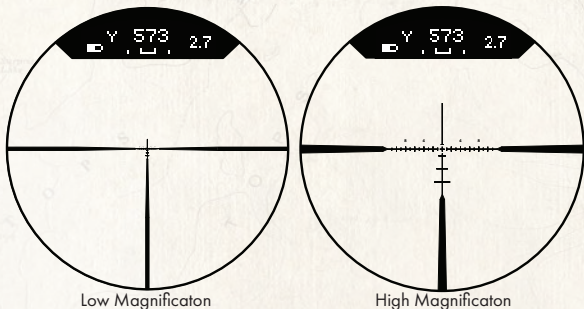

High Power settings take full advantage of the bullet drop compensating features, while Low Power settings create a highly visible duplex reticle for quick shots at close distances.

The display screen is visible above the vertical crosshair at any magnification.

DETAIL

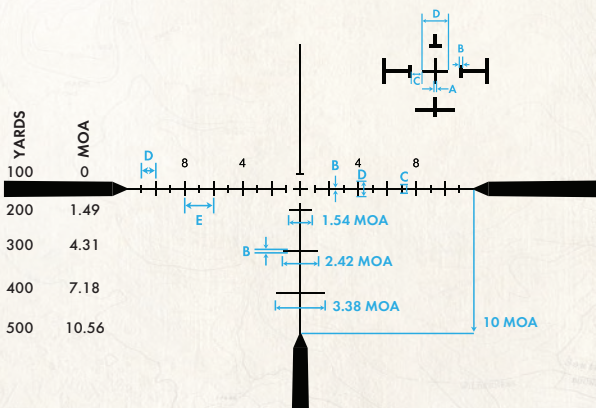

RETICLE SUBTENSIONS (MOA)

| FEATURE | MOA |
|---------|------|
| A | 0.1 |
| B | 0.13 |
| C | 0.5 |
| D | 1.0 |
| E | 2.0 |

FOREVER WARRANTY

The Veracity PH riflescope is covered by the Burris Forever Warranty™



All Burris Optics (with the exception of Thermal products) are covered by the Burris Forever Warranty™. We will repair or replace your Burris optic if it is damaged or defective. The warranty is automatically transferred to future owners.

- No repair or replacement charge
- No warranty card needed
- No receipt needed
- No questions asked

The Burris Forever Warranty does not cover loss, theft, deliberate damage, or cosmetic damage that does not hinder the performance of the product.



**FOR INSTRUCTIONAL VIDEOS AND MORE INFORMATION
VISIT US ONLINE AT BURRIS UNIVERSITY.**



Burris®

Burris Company
331 East 8th St., Greeley, CO 80631
(970) 356-1670
BurrisOptics.com
Facebook.com/BurrisOptics
INSTR-9200